

No. 109938

Filed March 8th, 1945 at 10 A.M.

## ZONING ORDINANCE

AITKIN COUNTY, MINNESOTA  
Effective January 1, 1945

## Ordinance

An Ordinance establishing districts and prescribing regulations therefore pursuant to laws of 1939, Chapter 340, (Mason's 1940 Supplement, Paragraph 669-37 to 669-59 inclusive.)

Whereas, Pursuant to Laws of Minnesota for 1939, Chapter 340, the county board of the county of Aitkin, state of Minnesota, after due investigation, notice, hearing, and other proceedings, as provided by said chapter, has determined to establish districts in said county and prescribe regulations therefore as hereinafter provided, and the same have been approved by the town boards of the areas affected:

NOW, THEREFORE, BE IT ORDAINED BY THE COUNTY BOARD OF THE COUNTY OF Aitkin, state of Minnesota:

Section 1. Districts--All of the unincorporated area of the county is hereby divided into districts of two types to be known as restricted and unrestricted districts, respectively, which districts are bounded and numbered as hereinafter described and as shown upon the official map, designated as the Zoning map of Aitkin County, Minnesota dated November 2, 1944, and certified as such by the chairman of the county board and the county auditor of said county, and filed in the office of said county auditor on November 2, 1944, a copy of which map is attached hereto and made a part of this ordinance as if fully described herein, including all notations, references, and other things shown on said map. All such districts exclude incorporated areas. Except as otherwise indicated, the boundaries of all such districts follow boundary lines of political subdivisions, center lines of highways and railways, lines established by the United States government survey, or legal sub-divisions thereof, and boundaries of lakes and streams.

## Section 2. Restricted Districts.

Districts No. 1 to 62 shall be restricted districts.

DISTRICT NO. 1 shall consist of the following described areas:

S $\frac{1}{2}$  of Section 3;  
S $\frac{1}{2}$  of Section 4;  
S $\frac{1}{2}$  of NE $\frac{1}{4}$ ,  
SE $\frac{1}{4}$  of NW $\frac{1}{4}$  and  
S $\frac{1}{2}$  of Section 7;  
S $\frac{1}{2}$  of Section 8;  
Sections 9, 10, 11;  
W $\frac{1}{2}$  of Section 12;  
Sections 13 to 36 both inclusive;  
all in TOWNSHIP 44--RANGE 22.

NE $\frac{1}{4}$ ,  
E $\frac{1}{2}$  of NW $\frac{1}{4}$  and the  
S $\frac{1}{2}$  of Section 1;  
SE $\frac{1}{4}$  of Section 2;  
NE $\frac{1}{4}$  of Section 11;  
N $\frac{1}{2}$  of Section 12;  
all in TOWNSHIP 43, RANGE 23.

E $\frac{1}{2}$  of Section 13;  
E $\frac{1}{2}$  of Section 24;  
NE $\frac{1}{4}$  and  
S $\frac{1}{2}$  of Section 25;  
section 36; all in  
TOWNSHIP 44, RANGE 23.

DISTRICT NO. 2 shall consist of the following described areas:

S $\frac{1}{2}$  of NE $\frac{1}{4}$ , S $\frac{1}{2}$  of NW $\frac{1}{4}$ ,  
N $\frac{1}{2}$  of SW $\frac{1}{4}$  and N $\frac{1}{2}$  of SE $\frac{1}{4}$ ; all in  
Section 6, TOWNSHIP 44, RANGE 22.

S $\frac{1}{2}$  of Section 1;  
S $\frac{1}{2}$  of Section 2;  
SE $\frac{1}{4}$  of Section 3;  
Section 10;  
W $\frac{1}{2}$  of Section 11;  
W $\frac{1}{2}$  of Section 14;  
Section 15;  
N $\frac{1}{2}$  of Section 22;  
all in TOWNSHIP 44, RANGE 23.

DISTRICT NO. 3 shall consist of the following described areas:

S $\frac{1}{2}$  of Section 13;  
SE $\frac{1}{4}$  of Section 14;  
NE $\frac{1}{4}$  of Section 23;  
NE $\frac{1}{4}$ , N $\frac{1}{2}$  of NW $\frac{1}{4}$  and  
SE $\frac{1}{4}$  of Sec. 24;  
NE $\frac{1}{4}$ , E $\frac{1}{2}$  of NW $\frac{1}{4}$ ,  
E $\frac{1}{2}$  of SW $\frac{1}{4}$  and SE $\frac{1}{4}$  of Sec. 25;  
NE $\frac{1}{4}$  of Sec. 35;  
W $\frac{1}{2}$  of NE $\frac{1}{4}$  and NW $\frac{1}{4}$  of Sec. 36;  
all in TOWNSHIP 45 RANGE 22.

DISTRICT NO. 4 shall consist of the following described areas:

Sec. 1;  
S $\frac{1}{2}$  of SW $\frac{1}{4}$  and  
S $\frac{1}{2}$  of SE $\frac{1}{4}$  of Sec. 2;  
S $\frac{1}{2}$  of Sec. 3;  
S $\frac{1}{2}$  of Sec. 4;  
Sec. 7;  
NE $\frac{1}{4}$ , S $\frac{1}{2}$  of NW $\frac{1}{4}$  and  
S $\frac{1}{2}$  of Sec. 8;  
Sec. 9;  
N $\frac{1}{2}$ , N $\frac{1}{2}$  of SW $\frac{1}{4}$  and  
N $\frac{1}{2}$  of SE $\frac{1}{4}$  of Sec. 10;  
N $\frac{1}{2}$  of Sec. 11;  
N $\frac{1}{2}$  of Sec. 12;  
SW $\frac{1}{4}$  of Sec. 15;  
Sec. 16;  
Sec. 17;  
Sec. 18;  
Sec. 19;  
Sec. 20;  
Sec. 21;  
N $\frac{1}{2}$  of NE $\frac{1}{4}$  and W $\frac{1}{2}$  of Sec. 28;  
Sec. 29; Sec. 30;  
N $\frac{1}{2}$  of Sec. 31;  
N $\frac{1}{2}$  of Sec. 32;  
all in TOWNSHIP 45, RANGE 22.

SW $\frac{1}{4}$  of Sec. 30;  
NW $\frac{1}{4}$  of Sec. 31;  
NE $\frac{1}{4}$ , E $\frac{1}{2}$  of SW $\frac{1}{4}$  and SE $\frac{1}{4}$  of Sec. 35;  
Sec. 36;  
all in TOWNSHIP 46, RANGE 22.

Sec. 1;  
Sec. 2;  
Sec. 3;  
E $\frac{1}{2}$  of Sec. 4;  
E $\frac{1}{2}$  of Sec. 9;  
Sections 10, 11, 12, 13, 14, 15;  
E $\frac{1}{2}$  of Sec. 16;  
E $\frac{1}{2}$  of Sec. 21;  
Sec's. 22, 23, 24, 25, 26, 27;  
NE $\frac{1}{4}$  of Sec. 28;  
all in TOWNSHIP 45, RANGE 23.

S $\frac{1}{2}$  of Sec. 25;  
E $\frac{1}{2}$  of SE $\frac{1}{4}$  of Sec. 26;  
E $\frac{1}{2}$  of SW $\frac{1}{4}$  and SE $\frac{1}{4}$  of Sec. 33;  
E $\frac{1}{2}$  of NE $\frac{1}{4}$  and E $\frac{1}{2}$  of SE $\frac{1}{4}$  of Sec. 35;  
Sec. 36;  
all in TOWNSHIP 46, RANGE 23.

(Continued to next page).

DISTRICT NO. 5 shall consist of the following described areas:

$S\frac{1}{2}$  of Sec. 29;  
NE $\frac{1}{4}$  and E $\frac{1}{2}$  of NW $\frac{1}{4}$  of Sec. 32;  
N $\frac{1}{2}$  of Sec. 33;  
W $\frac{1}{2}$  of NW $\frac{1}{4}$  of Sec. 34;  
all in TOWNSHIP 46, RANGE 22.

DISTRICT NO. 6 shall consist of the following described areas:

Sec. 1;  
Sec. 2;  
Sec. 3;  
Sec. 4;  
SE $\frac{1}{4}$  of Sec. 5;  
E $\frac{1}{2}$  of Sec. 8;  
Sec. 9;  
Sec. 10;  
Sec. 11;  
N $\frac{1}{2}$  and SE $\frac{1}{4}$  of Sec. 12;  
NE $\frac{1}{4}$  of Sec. 13;  
W $\frac{1}{2}$  of NE $\frac{1}{4}$ , W $\frac{1}{2}$ ,  
W $\frac{1}{2}$  of SE $\frac{1}{4}$  of Sec. 14;  
Sec. 15;  
Sec. 16;  
E $\frac{1}{2}$  of Sec. 17;  
N $\frac{1}{2}$  of NE $\frac{1}{4}$  of Sec. 20;  
NE $\frac{1}{4}$ , N $\frac{1}{2}$  of NW $\frac{1}{4}$ , SE $\frac{1}{4}$  of NW $\frac{1}{4}$ ,  
NE $\frac{1}{4}$  of SW $\frac{1}{4}$ , N $\frac{1}{2}$  of SE $\frac{1}{4}$  of Sec. 21;  
N $\frac{1}{2}$ , NW $\frac{1}{4}$  of SW $\frac{1}{4}$  and N $\frac{1}{2}$  of SE $\frac{1}{4}$  of Sec. 22;  
W $\frac{1}{2}$  of NE $\frac{1}{4}$  and NW $\frac{1}{4}$  of Sec. 23;  
all in TOWNSHIP 46, RANGE 22.

$S\frac{1}{2}$  of Sec. 28;  
SE $\frac{1}{4}$  of Sec. 29;  
NE $\frac{1}{4}$  and N $\frac{1}{2}$  of SE $\frac{1}{4}$  of Sec. 32;  
Sec. 33;  
 $S\frac{1}{2}$  of NE $\frac{1}{4}$ , NW $\frac{1}{4}$  of NW $\frac{1}{4}$ , S $\frac{1}{2}$  of NW $\frac{1}{4}$  and  
S $\frac{1}{2}$  of Sec. 34;  
Sec. 35;  
Sec. 36;  
all in TOWNSHIP 47, RANGE 22.

DISTRICT NO. 7 shall consist of the following described areas:

SW $\frac{1}{4}$  and W $\frac{1}{2}$  of SE $\frac{1}{4}$  of Sec. 31;  
all in TOWNSHIP 47, RANGE 22.

NW $\frac{1}{4}$  of Sec. 1;  
N $\frac{1}{2}$  of Sec. 2;  
E $\frac{1}{2}$  of NE $\frac{1}{4}$  of Sec. 3;  
all in TOWNSHIP 46, RANGE 23.

$S\frac{1}{2}$  of Sec. 25;  
 $S\frac{1}{2}$  of Sec. 26;  
 $S\frac{1}{2}$  of Sec. 27;  
N $\frac{1}{2}$  and E $\frac{1}{2}$  of SE $\frac{1}{4}$  of Sec. 34;  
Sec. 35;  
Sec. 36;  
all in TOWNSHIP 47, RANGE 23.

DISTRICT NO. 8 shall consist of the following described areas:

Sec. 1;  
Sec. 2;  
Sec. 3;  
 $S\frac{1}{2}$  of SW $\frac{1}{4}$  and  $S\frac{1}{2}$  of SE $\frac{1}{4}$  of Sec. 4;  
NE $\frac{1}{4}$ , E $\frac{1}{2}$  of NW $\frac{1}{4}$ , E $\frac{1}{2}$  of SW $\frac{1}{4}$ ,  
N $\frac{1}{2}$  of SE $\frac{1}{4}$  and SW $\frac{1}{4}$  of SE $\frac{1}{4}$  of Sec. 8;  
N $\frac{1}{2}$ , NW $\frac{1}{4}$  of SW $\frac{1}{4}$ ; E $\frac{1}{2}$  of SW $\frac{1}{4}$  and  
SE $\frac{1}{4}$  of Sec. 9;  
Sec. 10;  
Sec. 11;  
Sec. 12;  
Sec. 13;  
Sec. 14;  
all in TOWNSHIP 47, RANGE 22.

$S\frac{1}{2}$  of NE $\frac{1}{4}$  and SE $\frac{1}{4}$  of Sec. 25;  
SW $\frac{1}{4}$  of Sec. 28;  
N $\frac{1}{2}$ , Lot 3, NE $\frac{1}{4}$  of SE $\frac{1}{4}$ , Lot 2,  
Lot 1, of Sec. 33;  
W $\frac{1}{2}$  of NE $\frac{1}{4}$ , NW $\frac{1}{4}$ , and S $\frac{1}{2}$  of Sec. 34;  
NE $\frac{1}{4}$  and S $\frac{1}{2}$  of Sec. 35;  
Sec. 36;  
all in TOWNSHIP 48, RANGE 22.

DISTRICT NO. 9 shall consist of the following described areas:

Sec. 1 except Lot 1;  
Sec. 2;  
E $\frac{1}{2}$  of Sec. 3;  
Sec. 11;  
N $\frac{1}{2}$  of Sec. 12;  
all in TOWNSHIP 48, RANGE 22.

$S\frac{1}{2}$  of Sec. 26;  
SE $\frac{1}{4}$  of Sec. 27;  
NE $\frac{1}{4}$  and E $\frac{1}{2}$  of NW $\frac{1}{4}$  of Sec. 34;  
Sec. 35;  
all in TOWNSHIP 49, RANGE 22.

DISTRICT NO. 10 shall consist of the following described areas:

W $\frac{1}{2}$  of NE $\frac{1}{4}$ , W $\frac{1}{2}$  and W $\frac{1}{2}$  of SE $\frac{1}{4}$  of Sec. 6;  
Sec. 7;  
W $\frac{1}{2}$  and SE $\frac{1}{4}$  of Sec. 8;  
N $\frac{1}{2}$  of Sec. 17;  
NE $\frac{1}{4}$  and E $\frac{1}{2}$  of NW $\frac{1}{4}$  of Sec. 18;  
all in TOWNSHIP 48, RANGE 22.

Sec. 1;  
Sec. 2;  
Sec. 3;  
E $\frac{1}{2}$  of Sec. 4;  
Sec. 10;  
Sec. 11;  
Sec. 12;  
Sec. 14;  
Sec. 15;  
NE $\frac{1}{4}$  of Sec. 16;  
N $\frac{1}{2}$  of NE $\frac{1}{4}$  and N $\frac{1}{2}$  of NW $\frac{1}{4}$  of Sec. 22;  
all in TOWNSHIP 48, RANGE 23.

SE $\frac{1}{4}$  of Sec. 33;  
 $S\frac{1}{2}$  of Sec. 34;  
Sec. 35;  
W $\frac{1}{2}$  of NW $\frac{1}{4}$ , SW $\frac{1}{4}$ , and S $\frac{1}{2}$  of SE $\frac{1}{4}$  of Sec. 36;  
all in TOWNSHIP 49, RANGE 23.

DISTRICT NO. 11 shall consist of the following described areas:

W $\frac{1}{2}$  of NE $\frac{1}{4}$ , NW $\frac{1}{4}$ , N $\frac{1}{2}$  of SW $\frac{1}{4}$  and  
NW $\frac{1}{4}$  of SE $\frac{1}{4}$  of Sec. 4;  
E $\frac{1}{2}$  of Sec. 5;  
TOWNSHIP 48, RANGE 22.

$S\frac{1}{2}$  of SW $\frac{1}{4}$  of Sec. 28;  
Sec. 32;  
W $\frac{1}{2}$  of NE $\frac{1}{4}$ ; W $\frac{1}{2}$  and W $\frac{1}{2}$  of SE $\frac{1}{4}$  of Sec. 33;  
all in TOWNSHIP 49, RANGE 22.

DISTRICT NO. 12 shall consist of the following described areas:

SW $\frac{1}{4}$  of Sec. 16;  
 $S\frac{1}{2}$  of Sec. 17;  
SE $\frac{1}{4}$  and Lots 3, 4, 6, and 5 of Sec. 18;  
N $\frac{1}{2}$  of Sec. 19;  
N $\frac{1}{2}$  of Sec. 20;  
NW $\frac{1}{4}$  of Sec. 21;  
all in TOWNSHIP 49, RANGE 22.

DISTRICT NO. 13 shall consist of the following described areas:

Sec. 1;  
Sec. 2;  
E $\frac{1}{2}$  of Sec. 3;  
NW $\frac{1}{4}$  of Sec. 11;  
NE $\frac{1}{4}$  of Sec. 12;  
all in TOWNSHIP 49, RANGE 22.

DISTRICT NO. 14 shall consist of the following described areas:

W $\frac{1}{2}$  of Sec. 4;  
Sec. 5;  
Sec. 6;  
W $\frac{1}{2}$  of Sec. 7;  
all in TOWNSHIP 49, RANGE 22.

SECURITY PRINTING COMPANY, ST. CLOUD, MINN. 124398

Sec.1;  
Sec.2;  
E $\frac{1}{2}$  of NE $\frac{1}{4}$  and SE $\frac{1}{4}$  of Sec.3;  
NE $\frac{1}{4}$ , E $\frac{1}{2}$  of NW $\frac{1}{4}$ , E $\frac{1}{2}$  of SW $\frac{1}{4}$  and  
SE $\frac{1}{4}$  of Sec. 12;  
Lots 1 and 2;  
E $\frac{1}{2}$  of NW $\frac{1}{4}$ ;  
NE $\frac{1}{4}$  of SW $\frac{1}{4}$ ; and Lot 3 of Sec.13;  
all in TOWNSHIP 49, RANGE 23.

E $\frac{1}{2}$  of Sec.25;  
S $\frac{1}{2}$  of Sec. 35;  
Sec.36;  
all in TOWNSHIP 50, RANGE 23.

*See also tracts below in 50-23*

DISTRICT NO.15 shall consist of the following described areas:

All of TOWNSHIP 51, RANGE 22.

S $\frac{1}{2}$  of SW $\frac{1}{4}$ , and S $\frac{1}{2}$  of SE $\frac{1}{4}$  of Sec. 12;  
Sec. 13;  
Sec. 14;  
S $\frac{1}{2}$  of NE $\frac{1}{4}$ , S $\frac{1}{2}$  of NW $\frac{1}{4}$  and S $\frac{1}{2}$  of Sec.15;  
S $\frac{1}{2}$  of NE $\frac{1}{4}$  and S $\frac{1}{2}$  of Sec. 16;  
Sec's. 19 to 36, both inclusive;  
TOWNSHIP 52, RANGE 22.

Sec.1;  
Sec.2;  
Lots 3, 5, and 6, SE $\frac{1}{4}$  of SW $\frac{1}{4}$ ,  
Lots 7, Lot 8, S $\frac{1}{2}$  of SE $\frac{1}{4}$  of Sec.3;  
SW $\frac{1}{4}$  of NW $\frac{1}{4}$  and NW $\frac{1}{4}$  of SW $\frac{1}{4}$  of Sec. 4;  
S $\frac{1}{2}$  of NE $\frac{1}{4}$ , S $\frac{1}{2}$  of NW $\frac{1}{4}$ , N $\frac{1}{2}$  of SW $\frac{1}{4}$ ,  
N $\frac{1}{2}$  of SE $\frac{1}{4}$  of Sec.5;  
S $\frac{1}{2}$  of NE $\frac{1}{4}$ , S $\frac{1}{2}$  of NW $\frac{1}{4}$  and S $\frac{1}{2}$  of Sec.6;  
W $\frac{1}{2}$  and SE $\frac{1}{4}$  of Sec.7;  
E $\frac{1}{2}$  of NE $\frac{1}{4}$  and E $\frac{1}{2}$  of SE $\frac{1}{4}$  of Sec.10;  
Sec.11;  
Sec.12;  
Sec.13;  
Sec.14;  
Sec.15;  
all of Sec.16 except the NE $\frac{1}{4}$  of NE $\frac{1}{4}$ ;  
Sec.17;  
Sec.18;  
Sec.19;  
Sec.20;  
Sec.21;  
E $\frac{1}{2}$  of Sec.22;  
Sec.23;  
N $\frac{1}{2}$  of Sec.24;  
W $\frac{1}{2}$  of Sec.28;Sec.29;  
Sec.30;  
Lots 1 and 2 of Sec.31;  
Sec.32 north of lake;  
that part of NW $\frac{1}{4}$  No. of lake of Sec.33;  
all in TOWNSHIP 50, RANGE 23.

Sec.1;  
Sec.2;  
E $\frac{1}{2}$  of NE $\frac{1}{4}$ , Lots 1,2,8,7, E $\frac{1}{2}$  of SW $\frac{1}{4}$  and  
SE $\frac{1}{4}$  of Sec.10;  
Sec.11;  
Sec.12;  
Sec.13;  
Sec.14;  
Sec.15;  
Sec.23;  
Sec.24;  
Sec.25;  
NE $\frac{1}{4}$ , E $\frac{1}{2}$  of NW $\frac{1}{4}$ , Lots 3 and 2;  
SE $\frac{1}{4}$  of Sec.26;  
Sec.35;  
Sec.36;  
all in TOWNSHIP 51, RANGE 23.

E $\frac{1}{2}$  of Sec.24;  
NE $\frac{1}{4}$ , NE $\frac{1}{4}$  of SW $\frac{1}{4}$ , S $\frac{1}{2}$  of SW $\frac{1}{4}$  and  
SE $\frac{1}{4}$  of Sec.25;  
W $\frac{1}{2}$  of SW $\frac{1}{4}$  and SE $\frac{1}{4}$  of SW $\frac{1}{4}$  of Sec.26;  
S $\frac{1}{2}$  of Sec.27;  
Sec.34 except SW $\frac{1}{4}$  of SW $\frac{1}{4}$ ;  
Sec.35;  
Sec.36;  
all in TOWNSHIP 52, RANGE 23.

S $\frac{1}{2}$  of NE $\frac{1}{4}$  and SE $\frac{1}{4}$  of Sec.1;  
Lot 4, and S $\frac{1}{2}$  of NE $\frac{1}{4}$ , Lots 5,8,9, and 12 and  
SE $\frac{1}{4}$  of Sec.11;  
NE $\frac{1}{4}$  and S $\frac{1}{2}$  of Sec.12;  
Sec.13;  
NE $\frac{1}{4}$  of NE $\frac{1}{4}$ , Lots 1,2,3,and 6 of Sec.14;  
E $\frac{1}{2}$  of Sec.24;  
Lot 1 of Sec.36;  
all in TOWNSHIP 50, RANGE 24.

DISTRICT NO.16 shall consist of the following described areas:

W $\frac{1}{2}$  of Sec.2;  
Sec.3;  
Sec.4;  
E $\frac{1}{2}$  of Sec.5;  
N $\frac{1}{2}$  of Sec.9;  
N $\frac{1}{2}$  of Sec.10;  
N $\frac{1}{2}$  of NW $\frac{1}{4}$  of Sec.11;  
all in TOWNSHIP 52, RANGE 22.

DISTRICT NO.17 shall consist of the following described areas:

SE $\frac{1}{4}$  of Sec.23;  
SW $\frac{1}{4}$  of Sec.24;  
W $\frac{1}{2}$  and SE $\frac{1}{4}$  of Sec.25;  
E $\frac{1}{2}$  of Sec.26;  
W $\frac{1}{2}$  of Sec.27;  
Sec.28;  
E $\frac{1}{2}$  of Sec.29;  
E $\frac{1}{2}$  of Sec.32;  
Sec.33;  
Sec.34;  
Sec.35;  
Sec.36;  
all in TOWNSHIP 43, RANGE 23

DISTRICT NO.18 shall consist of the following described areas:

N $\frac{1}{2}$ , N $\frac{1}{2}$  of SW $\frac{1}{4}$  and N $\frac{1}{2}$  of SE $\frac{1}{4}$  of Sec.9;  
all in TOWNSHIP 43, RANGE 23.

DISTRICT NO.19 shall consist of the following described areas:

SW $\frac{1}{4}$  and W $\frac{1}{2}$  of SE $\frac{1}{4}$  of Sec.7;  
Sec.18;  
N $\frac{1}{2}$  of NE $\frac{1}{4}$ , and W $\frac{1}{2}$  of Sec.19;  
N $\frac{1}{2}$  of NW $\frac{1}{4}$  of Sec.30;  
W $\frac{1}{2}$  of Sec.31;  
all in TOWNSHIP 43, RANGE 23.

S $\frac{1}{2}$  of Sec.13;  
S $\frac{1}{2}$  of Sec.14;  
S $\frac{1}{2}$  of Sec.15;  
S $\frac{1}{2}$  of Sec.16;  
SE $\frac{1}{4}$  of Sec.17;  
N $\frac{1}{2}$  and SE $\frac{1}{4}$  of Sec.21;  
Sec's. 22 to 27 ,both inclusive;  
NE $\frac{1}{4}$  of Sec.28;  
Sec.33;  
Sec.34;  
Sec.35;  
Sec.36;  
all in TOWNSHIP 43, RANGE 24.

DISTRICT NO.20 shall consist of the following described areas:

W $\frac{1}{2}$  of NE $\frac{1}{4}$ , and NW $\frac{1}{4}$  of Sec.6;  
all in TOWNSHIP 43, RANGE 23.

S $\frac{1}{2}$  of Sec.30;  
Sec.31;  
all in TOWNSHIP 44, RANGE 23.

N $\frac{1}{2}$  of Sec.1;  
N $\frac{1}{2}$  of Sec.2;  
N $\frac{1}{2}$  of Sec.3 except Lot 2;  
all in TOWNSHIP 43, RANGE 24.

S $\frac{1}{2}$  of Sec.25;  
S $\frac{1}{2}$  of Sec.26;  
SE $\frac{1}{4}$  of Sec.27;  
Sec.34;  
Sec.35;  
Sec.36;  
all in TOWNSHIP 44, RANGE 24.

(Continued to next page)

SECURITY PRINTING COMPANY, ST. CLOUD, MINN. ---124398

DISTRICT NO. 21 shall consist of the following described areas:

SW $\frac{1}{4}$  of Sec. 6;  
Sec. 7;  
Sec. 18;  
N $\frac{1}{2}$  of Sec. 19;  
all in TOWNSHIP 44, RANGE 23.

SE $\frac{1}{4}$  of Sec. 1;  
W $\frac{1}{2}$  of SW $\frac{1}{4}$  of Sec. 2;  
S $\frac{1}{2}$  of Sec. 3;  
SW $\frac{1}{4}$  of Sec. 4;  
S $\frac{1}{2}$  of Sec. 5;  
E $\frac{1}{2}$  of Sec. 7;  
N $\frac{1}{2}$ , and SW $\frac{1}{4}$  of Sec. 8;  
Sec. 9;  
Sec. 10;  
W $\frac{1}{2}$  and S $\frac{1}{2}$  of SE $\frac{1}{4}$  of Sec. 11;  
S $\frac{1}{2}$  of SW $\frac{1}{4}$  and E $\frac{1}{2}$  of Sec. 12;  
Sec. 13;  
Sec. 14;  
Sec. 15;  
E $\frac{1}{2}$  of Sec. 16;  
W $\frac{1}{2}$  of Sec. 17;  
S $\frac{1}{2}$  of Sec. 18;  
NE $\frac{1}{4}$  of Sec. 19;  
NE $\frac{1}{4}$  of Sec. 22;  
N $\frac{1}{2}$  of Sec. 23;  
N $\frac{1}{2}$  of Sec. 24;  
all in Township 44, RANGE 24.

Sec. 13;  
N $\frac{1}{2}$  of NE $\frac{1}{4}$  and N $\frac{1}{2}$  of NW $\frac{1}{4}$  of Sec. 24;  
all in TOWNSHIP 44, RANGE 25.

DISTRICT NO. 22 shall consist of the following described areas:

W $\frac{1}{2}$  of Sec. 5;  
Sec. 6;  
Sec. 7;  
W $\frac{1}{2}$  of Sec. 8;  
W $\frac{1}{2}$  of Sec. 17;  
Sec. 18;  
Sec. 19;  
W $\frac{1}{2}$  of Sec. 20;  
NW $\frac{1}{4}$  of Sec. 29;  
N $\frac{1}{2}$  of Sec. 30;  
all in TOWNSHIP 45, RANGE 23.

Sec's 1 to 22, both inclusive;  
NE $\frac{1}{4}$ , and W $\frac{1}{2}$  of NW $\frac{1}{4}$ , NW $\frac{1}{4}$  of SW $\frac{1}{4}$ ,  
S $\frac{1}{2}$  of SW $\frac{1}{4}$  and NE $\frac{1}{4}$  of SE $\frac{1}{4}$  of Sec. 23;  
Sec. 24;  
N $\frac{1}{2}$ , E $\frac{1}{2}$  of SW $\frac{1}{4}$  and SE $\frac{1}{4}$  of Sec. 25;  
SW $\frac{1}{4}$  of NE $\frac{1}{4}$ , W $\frac{1}{2}$  and W $\frac{1}{2}$  of SE $\frac{1}{4}$  of Sec. 26;  
Sec. 27;  
Sec. 28;  
Sec. 29;  
Sec. 30;  
N $\frac{1}{2}$  of Sec. 31;  
N $\frac{1}{2}$  of Sec. 32;  
N $\frac{1}{2}$  of Sec. 33;  
N $\frac{1}{2}$  of Sec. 34;  
W $\frac{1}{2}$  of NE $\frac{1}{4}$  and NW $\frac{1}{4}$  of Sec. 35;  
all in TOWNSHIP 45, RANGE 24.

SW $\frac{1}{4}$  of Sec. 13;  
S $\frac{1}{2}$  of SW $\frac{1}{4}$  and SE $\frac{1}{4}$  of Sec. 14;  
S $\frac{1}{2}$  of Sec. 15;  
S $\frac{1}{2}$  of Sec. 16;  
S $\frac{1}{2}$  of Sec. 17;  
NE $\frac{1}{4}$ , Lots 1 and 2 and  
S $\frac{1}{2}$  of Sec. 19;  
Sec. 20;  
Sec. 21;  
Sec. 22;  
Sec. 23;  
S $\frac{1}{2}$  of NW $\frac{1}{4}$  and S $\frac{1}{2}$  of Sec. 24;  
Sec's. 25 to 30, both inclusive;  
NE $\frac{1}{4}$  and S $\frac{1}{2}$  of Sec. 31;  
Sec's 32 to 36 both inclusive;  
all in TOWNSHIP 46, RANGE 24.

N $\frac{1}{2}$ , E $\frac{1}{2}$  of SW $\frac{1}{4}$  and SE $\frac{1}{4}$  of Sec. 1;  
Lots 1 and 2 of Sec. 2;  
S $\frac{1}{2}$  of SE $\frac{1}{4}$  of Sec. 9;  
E $\frac{1}{2}$  of SE $\frac{1}{4}$  of Sec. 10;  
S $\frac{1}{2}$  of NE $\frac{1}{4}$ , SE $\frac{1}{4}$  of NW $\frac{1}{4}$  and S $\frac{1}{2}$  of Sec. 11;  
Sec. 12;  
Sec. 13;  
Sec. 14;  
Sec. 15;  
NE $\frac{1}{4}$ , N $\frac{1}{2}$  of SE $\frac{1}{4}$  and SE $\frac{1}{4}$  of SE $\frac{1}{4}$  of Sec. 16;  
NE $\frac{1}{4}$  and N $\frac{1}{2}$  of SE $\frac{1}{4}$  of Sec. 21;  
NE $\frac{1}{4}$  and E $\frac{1}{2}$  of NW $\frac{1}{4}$  of Sec. 22;  
N $\frac{1}{2}$  of Sec. 23;  
NE $\frac{1}{4}$ , E $\frac{1}{2}$  of NW $\frac{1}{4}$ , E $\frac{1}{2}$  of SW $\frac{1}{4}$  and  
SE $\frac{1}{4}$  of Sec. 24;  
Sec. 25;  
SE $\frac{1}{4}$  of NE $\frac{1}{4}$  and E $\frac{1}{2}$  of SE $\frac{1}{4}$  of Sec. 26;  
NE $\frac{1}{4}$  of Sec. 35;  
N $\frac{1}{2}$ , N $\frac{1}{2}$  of SW $\frac{1}{4}$  and N $\frac{1}{2}$  of SE $\frac{1}{4}$  of Sec. 36;  
all in TOWNSHIP 45, RANGE 25.

S $\frac{1}{2}$  of NE $\frac{1}{4}$ , S $\frac{1}{2}$  of NW $\frac{1}{4}$  and  
S $\frac{1}{2}$  of Sec. 15;  
Sec. 22;  
Sec. 23;  
NE $\frac{1}{4}$  and S $\frac{1}{2}$  of Sec. 24;  
Sec. 25;  
NE $\frac{1}{4}$  of NE $\frac{1}{4}$  and Lots 1, 2, 3, 4, 5, 6, 7 of  
Sec. 26;  
NE $\frac{1}{4}$  and E $\frac{1}{2}$  of SE $\frac{1}{4}$  of Sec. 27;  
S $\frac{1}{2}$  of SE $\frac{1}{4}$  of Sec. 35;  
S $\frac{1}{2}$  of SW $\frac{1}{4}$  and S $\frac{1}{2}$  of SE $\frac{1}{4}$  of Sec. 36;  
all in TOWNSHIP 46, RANGE 25.

DISTRICT NO. 23 shall consist of the following described areas:

NW $\frac{1}{4}$  of Sec. 7;  
all in TOWNSHIP 46, RANGE 23.

S $\frac{1}{2}$  of NE $\frac{1}{4}$ ; S $\frac{1}{2}$  of NW $\frac{1}{4}$  and  
S $\frac{1}{2}$  of Sec. 1;  
S $\frac{1}{2}$  of NE $\frac{1}{4}$  and SE $\frac{1}{4}$  of Sec. 2;  
NE $\frac{1}{4}$  of Sec. 11;  
N $\frac{1}{2}$ , and N $\frac{1}{2}$  of SW $\frac{1}{4}$  and  
N $\frac{1}{2}$  of SE $\frac{1}{4}$  of Sec. 12;  
all in TOWNSHIP 46, RANGE 24.

DISTRICT NO. 24 shall consist of the following described areas:

SW $\frac{1}{4}$  and W $\frac{1}{2}$  of SE $\frac{1}{4}$  of Sec. 14;  
S $\frac{1}{2}$  of Sec. 15;  
SE $\frac{1}{4}$  of Sec. 16;  
NE $\frac{1}{4}$  and N $\frac{1}{2}$  of NW $\frac{1}{4}$  of Sec. 22;  
W $\frac{1}{2}$  of NE $\frac{1}{4}$  and NW $\frac{1}{4}$  of Sec. 23;  
all in TOWNSHIP 47, RANGE 23.

DISTRICT NO. 25 shall consist of the following described areas:

SW $\frac{1}{4}$  of Sec. 6;  
W $\frac{1}{2}$  of Sec. 7;  
Lot 1 in Sec. 18;  
all in TOWNSHIP 47, RANGE 23.

Sec's. 1 to 4, both inclusive;  
E $\frac{1}{2}$  of Sec. 5;  
E $\frac{1}{2}$  of Sec. 8;  
Sec. 9;  
NE $\frac{1}{4}$  and N $\frac{1}{2}$  of NW $\frac{1}{4}$  of Sec. 11;  
Sec. 12;  
Sec. 16, except 24 acres along the East  
line in SE $\frac{1}{4}$ ;  
E $\frac{1}{2}$  of Sec. 17;  
all in TOWNSHIP 47, RANGE 24.

S $\frac{1}{2}$  of Sec. 33;  
S $\frac{1}{2}$  of Sec. 34;  
S $\frac{1}{2}$  of Sec. 35;  
S $\frac{1}{2}$  of Sec. 36;  
all in TOWNSHIP 48, RANGE 24.

SECURITY PRINTING COMPANY, ST. CLOUD, MINN. 55124398

DISTRICT NO.26 shall consist of the following described areas:

N $\frac{1}{2}$  of NW $\frac{1}{4}$  and SW $\frac{1}{4}$  of NW $\frac{1}{4}$  of Sec.1;  
 N $\frac{1}{2}$  and SW $\frac{1}{4}$  of Sec.2;  
 Sec.3;  
 NW $\frac{1}{4}$ , N $\frac{1}{2}$  of SW $\frac{1}{4}$ , SE $\frac{1}{4}$  of SW $\frac{1}{4}$  and SE $\frac{1}{4}$  of Sec. 4;  
 NE $\frac{1}{4}$  of Sec.5;  
 NE $\frac{1}{4}$  and E $\frac{1}{2}$  of NW $\frac{1}{4}$  of Sec.9;  
 N $\frac{1}{2}$  of Sec.10;  
 NW $\frac{1}{4}$  of Sec.11;  
 all in TOWNSHIP 47, RANGE 23.

S $\frac{1}{2}$  of NE $\frac{1}{4}$ . S $\frac{1}{2}$  of NW $\frac{1}{4}$  and S $\frac{1}{2}$  of Sec.25;  
 S $\frac{1}{2}$  of NW $\frac{1}{4}$  and S $\frac{1}{2}$  of Sec.26;  
 Lot 1, Lot 6, and S $\frac{1}{2}$  of Sec.32;  
 Sec.33;  
 W $\frac{1}{2}$  of NW $\frac{1}{4}$  and W $\frac{1}{2}$  of SW $\frac{1}{4}$  of Sec.34;  
 Sec.35;  
 Sec.36;  
 all in TOWNSHIP 48, RANGE 23.

DISTRICT NO.27 shall consist of the following described areas:

SW $\frac{1}{4}$  of Sec.5;  
 SE $\frac{1}{4}$  of Sec.6;  
 E $\frac{1}{2}$  of Sec.7;  
 W $\frac{1}{2}$  of NE $\frac{1}{4}$ , W $\frac{1}{2}$  and W $\frac{1}{2}$  of SE $\frac{1}{4}$  of Sec.8;  
 W $\frac{1}{2}$  of Sec.17;  
 E $\frac{1}{2}$  of Sec.18;  
 E $\frac{1}{2}$  of Sec.19;  
 W $\frac{1}{2}$  of Sec.20;  
 all in TOWNSHIP 48, RANGE 23.

DISTRICT NO.28 shall consist of the following described areas:

SE $\frac{1}{4}$  of SE $\frac{1}{4}$  of Sec.9;  
 S $\frac{1}{2}$  of SW $\frac{1}{4}$  and S $\frac{1}{2}$  of SE $\frac{1}{4}$  of Sec.10;  
 S $\frac{1}{2}$  of SW $\frac{1}{4}$  of Sec.11;  
 NW $\frac{1}{4}$  and N $\frac{1}{2}$  of SW $\frac{1}{4}$  of Sec.14;  
 Sec.15;  
 E $\frac{1}{2}$  of NE $\frac{1}{4}$  and NE $\frac{1}{4}$  of SE $\frac{1}{4}$  of Sec.16;  
 all in TOWNSHIP 49, RANGE 23.

DISTRICT NO.29 shall consist of the following described areas:

SW $\frac{1}{4}$  of Sec.16;  
 SE $\frac{1}{4}$  of Sec.17;  
 E $\frac{1}{2}$  of Sec.20;  
 W $\frac{1}{2}$  of NE $\frac{1}{4}$ , W $\frac{1}{2}$  and W $\frac{1}{2}$  of SE $\frac{1}{4}$  of Sec.21;  
 W $\frac{1}{2}$  of Sec. 28;  
 E $\frac{1}{2}$  of Sec.29;  
 all in TOWNSHIP 51, RANGE 23.

DISTRICT NO. 30 shall consist of the following described areas:

W $\frac{1}{2}$  of Sec.18;  
 W $\frac{1}{2}$  of Sec.19;  
 SW $\frac{1}{4}$  of Sec.30;  
 NW $\frac{1}{4}$  of Sec.31;  
 all in TOWNSHIP 51, RANGE 23.

E $\frac{1}{2}$  of SE $\frac{1}{4}$  of Sec. 13;  
 NE $\frac{1}{4}$ , E $\frac{1}{2}$  of NW $\frac{1}{4}$ , E $\frac{1}{2}$  of SW $\frac{1}{4}$  and SE $\frac{1}{4}$  of Sec.24;  
 Sec.25;  
 SE $\frac{1}{4}$  of Sec.26;  
 NE $\frac{1}{4}$ , S $\frac{1}{2}$  of NW $\frac{1}{4}$ , N $\frac{1}{2}$  of SW $\frac{1}{4}$  and N $\frac{1}{2}$  of SE $\frac{1}{4}$  of Sec. 35;  
 N $\frac{1}{2}$ , N $\frac{1}{2}$  of SW $\frac{1}{4}$  and N $\frac{1}{2}$  of SE $\frac{1}{4}$  of Sec.36;  
 all in TOWNSHIP 51, RANGE 24.

DISTRICT NO.31 shall consist of the following described areas:

SW $\frac{1}{4}$  of Sec.4;  
 E $\frac{1}{2}$  of Sec.8;  
 W $\frac{1}{2}$  of Sec.9;  
 all in TOWNSHIP 51, RANGE 23.

DISTRICT NO.32 shall consist of the following described areas:

Sec.1;  
 Sec.2;  
 NE $\frac{1}{4}$ , E $\frac{1}{2}$  of NW $\frac{1}{4}$  and E $\frac{1}{2}$  of SE $\frac{1}{4}$  of Sec.3;  
 NE $\frac{1}{4}$ , N $\frac{1}{2}$  of NW $\frac{1}{4}$ , Lots 4 and 9 of Sec.11;  
 N $\frac{1}{2}$  of NE $\frac{1}{4}$ , Lot 2, SE $\frac{1}{4}$  of NE $\frac{1}{4}$ ,  
 N $\frac{1}{2}$  of NW $\frac{1}{4}$ , Lot 5, Lot 4 and Lot 1 of Sec. 12;  
 all in TOWNSHIP 52, RANGE 23.

DISTRICT NO.33 shall consist of the following described areas:

SW $\frac{1}{4}$  of Sec.18;  
 W $\frac{1}{2}$  of Sec. 19;  
 all in TOWNSHIP 52, RANGE 23.  
  
 Lots 2, 3, 4, 5, 6, 9, 10, 11, 12 and 14;  
 all in TOWNSHIP 50, RANGE 24. *Sec.6 No Sect.*

W $\frac{1}{2}$  of NW $\frac{1}{4}$  and W $\frac{1}{2}$  of SW $\frac{1}{4}$  of Sec.1;  
 Sec's. 2 to 10, both inclusive;  
 NW $\frac{1}{4}$  of Sec.11;  
 NW $\frac{1}{4}$  and W $\frac{1}{2}$  of SW $\frac{1}{4}$  of Sec. 15;  
 Sec.16;  
 Sec. 17;  
 Sec. 18;  
 Sec. 19;  
 Sec. 20;  
 W $\frac{1}{2}$  of NE $\frac{1}{4}$ , W $\frac{1}{2}$  and W $\frac{1}{2}$  of SE $\frac{1}{4}$  of Sec.21;  
 W $\frac{1}{2}$  of NE $\frac{1}{4}$ , NW $\frac{1}{4}$  and NW $\frac{1}{4}$  of SW $\frac{1}{4}$  of Sec.28;  
 N $\frac{1}{2}$  and N $\frac{1}{2}$  of SW $\frac{1}{4}$ , N $\frac{1}{2}$  of SE $\frac{1}{4}$  of Sec.29;  
 Sec.30;  
 N $\frac{1}{2}$  of NW $\frac{1}{4}$ , SW $\frac{1}{4}$  of NW $\frac{1}{4}$ , NW $\frac{1}{4}$  of SW $\frac{1}{4}$ ,  
 S $\frac{1}{2}$  of SW $\frac{1}{4}$  and SW $\frac{1}{4}$  of SE $\frac{1}{4}$  of Sec.31;  
 all in TOWNSHIP 51, RANGE 24.

S $\frac{1}{2}$  of Sec.13;  
 S $\frac{1}{2}$  of Sec.14;  
 SE $\frac{1}{4}$  of Sec.15;  
 SW $\frac{1}{4}$  of Sec.16;  
 S $\frac{1}{2}$  of Sec.17;  
 S $\frac{1}{2}$  of Sec. 18;  
 Sec's. 19 to 35, both inclusive;  
 N $\frac{1}{2}$  of NE $\frac{1}{4}$ , N $\frac{1}{2}$  of NW $\frac{1}{4}$ , SW $\frac{1}{4}$  of NW $\frac{1}{4}$   
 and W $\frac{1}{2}$  of SW $\frac{1}{4}$  of Sec. 36;  
 all in TOWNSHIP 52, RANGE 24.

Sec.1;  
 Sec.2;  
 Sec.3;  
 Lot 1 S $\frac{1}{2}$  of NE $\frac{1}{4}$  and SE $\frac{1}{4}$  of Sec.4;  
 W $\frac{1}{2}$  of Sec.5;  
 Sec.6;  
 N $\frac{1}{2}$  and N $\frac{1}{2}$  of SW $\frac{1}{4}$  and N $\frac{1}{2}$  of SE $\frac{1}{4}$  of Sec,7;  
 NW $\frac{1}{4}$  of Sec.8;  
 NE $\frac{1}{4}$  of Sec.9;  
 N $\frac{1}{2}$  of Sec.10;  
 N $\frac{1}{2}$  of Sec.11;  
 all in TOWNSHIP 50, RANGE 25.

Sec's. 1 to 20, both inclusive;  
 W $\frac{1}{2}$  of NW $\frac{1}{4}$  of Sec.21;  
 Sec's. 22 to 27, both inclusive;  
 E $\frac{1}{2}$  of NE $\frac{1}{4}$  and E $\frac{1}{2}$  of SE $\frac{1}{4}$  of Sec.28;  
 N $\frac{1}{2}$ , SW $\frac{1}{4}$ , N $\frac{1}{2}$  of SE $\frac{1}{4}$  of Sec.29;  
 E $\frac{1}{2}$  of Sec. 30;  
 Sec.31;  
 W $\frac{1}{2}$  of Sec.32;  
 E $\frac{1}{2}$  of NE $\frac{1}{4}$  and E $\frac{1}{2}$  of SE $\frac{1}{4}$  of Sec.33;  
 Sec.34;  
 Sec.35;  
 Sec.36;  
 all in TOWNSHIP 51, RANGE 25.

S $\frac{1}{2}$  of Sec.13;  
 S $\frac{1}{2}$  of Sec. 14;  
 S $\frac{1}{2}$  of Sec. 15;  
 S $\frac{1}{2}$  of Sec. 16;  
 SE $\frac{1}{4}$  of Sec. 17;  
 Sec's. 20 to 36, both inclusive;  
 all in TOWNSHIP 52, RANGE 25.

Sec.1;  
 NE $\frac{1}{4}$ , E $\frac{1}{2}$  of NW $\frac{1}{4}$ , E $\frac{1}{2}$  of SW $\frac{1}{4}$  and SE $\frac{1}{4}$  of Sec.2;  
 NE $\frac{1}{4}$ , E $\frac{1}{2}$  of NW $\frac{1}{4}$ , NE $\frac{1}{4}$  of SW $\frac{1}{4}$  and N $\frac{1}{2}$  of SE $\frac{1}{4}$  of Sec. 11;  
 N $\frac{1}{2}$ , N $\frac{1}{2}$  of SW $\frac{1}{4}$  and N $\frac{1}{2}$  of SE $\frac{1}{4}$  of Sec. 12;  
 all in TOWNSHIP 50, RANGE 26.

SECURITY PRINTING COMPANY, ST. CLOUD, MINN. --- 124398

$\frac{1}{2}$  of NE $\frac{1}{4}$ , SE $\frac{1}{4}$  of NW $\frac{1}{4}$ , E $\frac{1}{2}$  of SW $\frac{1}{4}$   
and SE $\frac{1}{4}$  of Sec.12;  
NE $\frac{1}{4}$ , E $\frac{1}{2}$  of NW $\frac{1}{4}$  and SE $\frac{1}{4}$  of Sec. 13;  
NE $\frac{1}{4}$ , E $\frac{1}{2}$  of NW $\frac{1}{4}$ , E $\frac{1}{2}$  of SW $\frac{1}{4}$   
and SE $\frac{1}{4}$  of Sec.35;  
Sec.36;  
all in TOWNSHIP 51, RANGE 26.

SE $\frac{1}{4}$  of Sec.24;  
Sec. 25;  
E $\frac{1}{2}$  of NE $\frac{1}{4}$  and E $\frac{1}{2}$  of SE $\frac{1}{4}$  of Sec. 26;  
E $\frac{1}{2}$  of NE $\frac{1}{4}$  of Sec.35;  
N $\frac{1}{2}$  of NE $\frac{1}{4}$  and NW $\frac{1}{4}$  of Sec.36;  
all in TOWNSHIP 52, RANGE 26.

DISTRICT NO.34 shall consist of  
the following described areas:

S $\frac{1}{2}$  of NW $\frac{1}{4}$  and SW $\frac{1}{4}$  of Sec.25;  
W $\frac{1}{2}$  of NE $\frac{1}{4}$ , W $\frac{1}{2}$  and W $\frac{1}{2}$  of SE $\frac{1}{4}$  of Sec.36;  
all in TOWNSHIP 44, RANGE 25.

DISTRICT NO. 35 shall consist of  
the following described areas:

Sec.17;  
NW $\frac{1}{4}$ , NE $\frac{1}{4}$  of SW $\frac{1}{4}$ , Lot 3, SE $\frac{1}{4}$  of SW $\frac{1}{4}$   
and SE $\frac{1}{4}$  of Sec.20;  
SW $\frac{1}{4}$  of Sec.21;  
NW $\frac{1}{4}$  of Sec.28;  
N $\frac{1}{2}$  of Sec.29;  
all in TOWNSHIP 44, RANGE 25.

DISTRICT NO. 36 shall consist of  
the following described areas:

SE $\frac{1}{4}$  of SW $\frac{1}{4}$  and S $\frac{1}{2}$  of SE $\frac{1}{4}$  of Sec.7;  
S $\frac{1}{2}$  of SW $\frac{1}{4}$  and SW $\frac{1}{4}$  of SE $\frac{1}{4}$  of Sec.8;  
W $\frac{1}{2}$  of NE $\frac{1}{4}$ , NW $\frac{1}{4}$  and W $\frac{1}{2}$  of SW $\frac{1}{4}$  of Sec.17;  
Sec.18;  
W $\frac{1}{2}$  of NE $\frac{1}{4}$ , W $\frac{1}{2}$  and W $\frac{1}{2}$  of SE $\frac{1}{4}$  of Sec.19;  
all in TOWNSHIP 45, RANGE 25.

E $\frac{1}{2}$  of NE $\frac{1}{4}$  and E $\frac{1}{2}$  of SE $\frac{1}{4}$  of Sec.8;  
NW $\frac{1}{4}$  and S $\frac{1}{2}$  of Sec.9;  
S $\frac{1}{2}$  of NE $\frac{1}{4}$  and S $\frac{1}{2}$  of Sec. 10;  
S $\frac{1}{2}$  of NE $\frac{1}{4}$ , S $\frac{1}{2}$  of NW $\frac{1}{4}$ , N $\frac{1}{2}$  of SW $\frac{1}{4}$   
and N $\frac{1}{2}$  of SE $\frac{1}{4}$  of Sec.11;  
S $\frac{1}{2}$  of Sec. 12;  
Sec. 13;  
NE $\frac{1}{4}$  and S $\frac{1}{2}$  of Sec. 14;  
W $\frac{1}{2}$  of Sec.15;  
Sec. 16;  
E $\frac{1}{2}$  of NE $\frac{1}{4}$  of Sec. 17;  
N $\frac{1}{2}$  of Sec. 24;  
all in TOWNSHIP 45, RANGE 26.

DISTRICT NO. 37 shall consist of  
the following described areas:

Sec.1;  
E $\frac{1}{2}$  of Sec.2;  
N $\frac{1}{2}$  of NW $\frac{1}{4}$  of Sec.12;  
all in TOWNSHIP 46, RANGE 25.

Sec.24;  
Sec.25;  
SE $\frac{1}{4}$  of NE $\frac{1}{4}$  and E $\frac{1}{2}$  of SE $\frac{1}{4}$  of Sec.26;  
E $\frac{1}{2}$  of Sec.36;  
all in TOWNSHIP 47, RANGE 25.

DISTRICT NO.38 shall consist of  
the following described areas:

SW $\frac{1}{4}$  of NW $\frac{1}{4}$ , NW $\frac{1}{4}$  of SW $\frac{1}{4}$  and  
S $\frac{1}{2}$  of SW $\frac{1}{4}$  of Sec.27;  
SE $\frac{1}{4}$  of NE $\frac{1}{4}$  and E $\frac{1}{2}$  of SE $\frac{1}{4}$  of Sec. 28;  
E $\frac{1}{2}$  of SE $\frac{1}{4}$  of Sec.32;  
N $\frac{1}{2}$  and SW $\frac{1}{4}$  of Sec.35;  
NW $\frac{1}{4}$  of Sec.34;  
all in TOWNSHIP 47, RANGE 25.

DISTRICT NO.39 shall consist of  
the following described areas:

Lots 12, 13, 10, 11, 9, 8, 7 in Sec. 6;  
W $\frac{1}{2}$  of Sec.7;  
all in TOWNSHIP 47, RANGE 24.

S $\frac{1}{2}$  of SE $\frac{1}{4}$  of Sec.1;  
E $\frac{1}{2}$  of SE $\frac{1}{4}$  of Sec.11;  
Sec.12;  
NW $\frac{1}{4}$  of NE $\frac{1}{4}$  and N $\frac{1}{2}$  of NW $\frac{1}{4}$  of Sec.13;  
all in TOWNSHIP 47, RANGE 25/

DISTRICT NO. 40 shall consist of  
the following described areas:

Lots 2 and 3 of Sec.1;  
Sec.2; except Lot 2;  
S $\frac{1}{2}$  of Sec.3;  
NE $\frac{1}{4}$  of Sec.9;  
N $\frac{1}{2}$  of Sec.10;  
all in TOWNSHIP 47, RANGE 25.

S $\frac{1}{2}$  of NE $\frac{1}{4}$ ; SE $\frac{1}{4}$  of NW $\frac{1}{4}$ ,  
NE $\frac{1}{4}$  of SW $\frac{1}{4}$ , S $\frac{1}{2}$  of SW $\frac{1}{4}$   
and SE $\frac{1}{4}$  of Sec.36,  
all in TOWNSHIP 48  
RANGE 25.

DISTRICT NO.41 shall consist of  
the following described areas:

Lots 2,3,4, NW $\frac{1}{4}$  of NW $\frac{1}{4}$ , Lot 5  
and SE $\frac{1}{4}$  of SW $\frac{1}{4}$  of Sec. 25;  
E $\frac{1}{2}$  of SE $\frac{1}{4}$  of Sec.26;  
E $\frac{1}{2}$  of NE $\frac{1}{4}$  and E $\frac{1}{2}$  of SE $\frac{1}{4}$  of Sec.35;  
W $\frac{1}{2}$  of Sec.36;  
all in TOWNSHIP 49, RANGE 24.

DISTRICT NO. 42 shall consist of  
the following described areas:

Sec's. 4 to 9, both inclusive ;  
N $\frac{1}{2}$ , N $\frac{1}{2}$  of SW $\frac{1}{4}$  and N $\frac{1}{2}$  of SE $\frac{1}{4}$  of Sec.17;  
N $\frac{1}{2}$ , N $\frac{1}{2}$  of SW $\frac{1}{4}$  and N $\frac{1}{2}$  of SE $\frac{1}{4}$  of Sec.18;  
all in TOWNSHIP 48, RANGE 24.

S $\frac{1}{2}$  of NE $\frac{1}{4}$ , S $\frac{1}{2}$  of NW $\frac{1}{4}$  and S $\frac{1}{2}$  of Sec.31;  
S $\frac{1}{2}$  of Sec.32;  
Sec.33;  
all in TOWNSHIP 49, RANGE 24.

Sec.1;  
SE $\frac{1}{4}$  of Sec.11;  
Sec.12;  
all in TOWNSHIP 48, RANGE 25.

E $\frac{1}{2}$  of Sec.35;  
Sec.36;  
all in TOWNSHIP 49, RANGE 25

DISTRICT NO.43 shall consist of the  
following described areas:

SE $\frac{1}{4}$  of Sec.11;  
NW $\frac{1}{4}$  of NE $\frac{1}{4}$ , S $\frac{1}{2}$  of NE $\frac{1}{4}$ , NW $\frac{1}{4}$  of SE $\frac{1}{4}$ ,  
Lots 2,1, of Sec.14;  
Lot 1, NW $\frac{1}{4}$  of NW $\frac{1}{4}$  and Lot 2 of Sec.23;  
all in TOWNSHIP 49, RANGE 24.

\* DISTRICT NO.44 shall consist of  
the following described areas:

NE $\frac{1}{4}$  and W $\frac{1}{2}$  of Sec.3;  
Lot 6, Sec.7;  
Lot 1, Sec. 8;  
SE $\frac{1}{4}$  of Sec.9;  
W $\frac{1}{2}$  of NE $\frac{1}{4}$ , W $\frac{1}{2}$  and W $\frac{1}{2}$  of SE $\frac{1}{4}$  of Sec.10;  
W $\frac{1}{2}$  of NE $\frac{1}{4}$  and NW $\frac{1}{4}$  of Sec.15;  
NE $\frac{1}{4}$  and SW $\frac{1}{4}$  of Sec.16;  
Sec.17; except E $\frac{1}{2}$  of NE $\frac{1}{4}$  and Lots 2 and 3;  
Lots 1 and 7, Sec.18;  
all in TOWNSHIP 49, RANGE 24.

That part of Sec.34 south of the river;  
W $\frac{1}{2}$  of Sec.35;  
all in TOWNSHIP 50, RANGE 24.

DISTRICT NO. 45 shall consist of the following described areas:

NE $\frac{1}{4}$  of Sec. 5;  
N $\frac{1}{2}$  of Sec. 6;  
all in TOWNSHIP 49, RANGE 24.

W $\frac{1}{2}$  of Sec. 4;  
All of Sec. 5, except Lots 3 and 4;  
Sec. 8;  
N $\frac{1}{2}$  of Sec. 9;  
S $\frac{1}{2}$  of Sec. 16;  
Sec. 17;  
SE $\frac{1}{4}$  of Sec. 18;  
Sec. 19;  
Sec. 20;  
Sec. 21;  
W $\frac{1}{2}$  of Sec. 28;  
Sec. 29;  
Sec. 30;  
Sec. 31;  
Sec. 32;  
all in TOWNSHIP 50, RANGE 24.

SE $\frac{1}{4}$  of Sec. 32;  
S $\frac{1}{2}$  of Sec. 33;  
all in TOWNSHIP 51, RANGE 24.

Sec. 1;  
Lots 1, 2, and 3, SE $\frac{1}{4}$  of NE $\frac{1}{4}$   
and E $\frac{1}{2}$  of SE $\frac{1}{4}$  of Sec. 2;  
all in TOWNSHIP 49, RANGE 25.

E $\frac{1}{2}$  of Sec. 35;  
Sec. 36;  
all in TOWNSHIP 50, RANGE 25.

DISTRICT NO. 46 shall consist of the following described areas:

S $\frac{1}{2}$  of Sec. 2;  
SE $\frac{1}{4}$  of Sec. 3;  
NE $\frac{1}{4}$  of Sec. 10;  
N $\frac{1}{2}$  of Sec. 11;  
all in TOWNSHIP 52, RANGE 24.

DISTRICT NO. 47 shall consist of the following described areas:

N $\frac{1}{2}$ , SW $\frac{1}{4}$  and N $\frac{1}{2}$  of SE $\frac{1}{4}$  of Sec. 5;  
Sec. 6;  
N $\frac{1}{2}$  of Sec. 7;  
NW $\frac{1}{4}$  of Sec. 8;  
all in TOWNSHIP 52, RANGE 24.

Sec's. 1 to 4, both inclusive;  
S $\frac{1}{2}$  of Sec. 5;  
SE $\frac{1}{4}$  of Sec. 6;  
NE $\frac{1}{4}$  of Sec. 7;  
N $\frac{1}{2}$  of Sec. 8;  
N $\frac{1}{2}$  of Sec. 9;  
N $\frac{1}{2}$  of Sec. 10;  
N $\frac{1}{2}$  of Sec. 11;  
N $\frac{1}{2}$  of Sec. 12;  
all in TOWNSHIP 52, RANGE 25.

DISTRICT NO. 48 shall consist of the following described areas:

SW $\frac{1}{4}$  and W $\frac{1}{2}$  of SE $\frac{1}{4}$  of Sec. 18;  
W $\frac{1}{2}$  of NE $\frac{1}{4}$ , NW $\frac{1}{4}$ , N $\frac{1}{2}$  of SW $\frac{1}{4}$   
and NW $\frac{1}{4}$  of SE $\frac{1}{4}$  of Sec. 19;  
all in TOWNSHIP 45, RANGE 26.

DISTRICT NO. 49 shall consist of the following described areas:

Sec. 6;  
NW $\frac{1}{4}$  of Sec. 7;  
all in TOWNSHIP 45, RANGE 26.

DISTRICT NO. 50 shall consist of the following described areas:

Lot 7, Sec. 6;  
all in TOWNSHIP 48, RANGE 25.

Lots 2 and 4; SW $\frac{1}{4}$  of NE $\frac{1}{4}$ , Lot 5,  
SW $\frac{1}{4}$  and W $\frac{1}{2}$  of SE $\frac{1}{4}$  of Sec. 1;  
Lots 5, 9, and 8 of Sec. 2;  
Lots 9 and 6 of Sec. 11;  
NE $\frac{1}{4}$ , E $\frac{1}{2}$  of NW $\frac{1}{4}$ , E $\frac{1}{2}$  of SW $\frac{1}{4}$   
and SE $\frac{1}{4}$  of Sec. 12;

Sec. 13;  
E $\frac{1}{2}$  of NE $\frac{1}{4}$  and SE $\frac{1}{4}$  of Sec. 14;  
E $\frac{1}{2}$  of Sec. 23;  
Sec. 24;  
all in TOWNSHIP 48, RANGE 26.  
Lot 3 of Sec. 36;  
all in TOWNSHIP 49, RANGE 26.  
DISTRICT NO. 51 shall consist of the following described areas:

X NW $\frac{1}{4}$  of Sec. 3;  
NE $\frac{1}{4}$  of Sec. 4;  
Sec. 6;  
Sec. 7;  
W $\frac{1}{2}$  of Sec. 8;  
W $\frac{1}{2}$  of Sec. 17;  
Sec. 18;  
N $\frac{1}{2}$ , N $\frac{1}{2}$  of SW $\frac{1}{4}$  and N $\frac{1}{2}$  of SE $\frac{1}{4}$  of Sec. 19;  
NW $\frac{1}{4}$ , Lots 3 and 4 of Sec. 20;  
all in TOWNSHIP 49, RANGE 25.

SW $\frac{1}{4}$  of Sec. 15;  
SW $\frac{1}{4}$  of NW $\frac{1}{4}$  and S $\frac{1}{2}$  of Sec. 16;  
S $\frac{1}{2}$  of NE $\frac{1}{4}$ , S $\frac{1}{2}$  of SW $\frac{1}{4}$  and SE $\frac{1}{4}$  of Sec. 17;  
S $\frac{1}{2}$  of NE $\frac{1}{4}$ , S $\frac{1}{2}$  of NW $\frac{1}{4}$  and S $\frac{1}{2}$  of Sec. 18;  
Sec. 19; Sec. 20;  
Sec. 21;  
W $\frac{1}{2}$  of Sec. 22;  
W $\frac{1}{2}$  of Sec. 27;  
Sec's. 28 to 33, both inclusive;  
SW $\frac{1}{4}$  of Sec. 34;  
all in TOWNSHIP 50, RANGE 25.

E $\frac{1}{2}$  of NE $\frac{1}{4}$  and E $\frac{1}{2}$  of SE $\frac{1}{4}$  of Sec. 12;  
E $\frac{1}{2}$  of Sec. 13;  
NE $\frac{1}{4}$  of Sec. 24;  
all in TOWNSHIP 49, RANGE 26.

S $\frac{1}{2}$  of NE $\frac{1}{4}$ , S $\frac{1}{2}$  of NW $\frac{1}{4}$  and S $\frac{1}{2}$  of Sec. 13;  
S $\frac{1}{2}$  of NE $\frac{1}{4}$ , SE $\frac{1}{4}$  of NW $\frac{1}{4}$ , E $\frac{1}{2}$  of SW $\frac{1}{4}$   
and SE $\frac{1}{4}$  of Sec. 14;  
NE $\frac{1}{4}$ , E $\frac{1}{2}$  of NW $\frac{1}{4}$ , E $\frac{1}{2}$  of SW $\frac{1}{4}$ , N $\frac{1}{2}$  of SE $\frac{1}{4}$   
and SW $\frac{1}{4}$  of SE $\frac{1}{4}$  of Sec. 23;  
Sec. 24;  
E $\frac{1}{2}$  of Sec. 25;  
E $\frac{1}{2}$  of Sec. 36; all in TOWNSHIP 50, RANGE 26.

DISTRICT NO. 52 shall consist of the following described areas:

Lot 3 of Sec. 4;  
all in TOWNSHIP 47, RANGE 26.

Lots 4 and 5 of Sec. 21;  
NE $\frac{1}{4}$ , Lots 8, 7, 6, 5, and E $\frac{1}{2}$  of SE $\frac{1}{4}$   
of Sec. 28;  
NE $\frac{1}{4}$  of NE $\frac{1}{4}$ , Lots 10, 9, 8, 7, 6, of Sec. 33;  
all in TOWNSHIP 48, RANGE 26.

DISTRICT NO. 53 shall consist of the following described areas:

S $\frac{1}{2}$  of NE $\frac{1}{4}$  and SE $\frac{1}{4}$  of Sec. 8;  
W $\frac{1}{2}$  of Sec. 16;  
E $\frac{1}{2}$  of Sec. 17;  
NE $\frac{1}{4}$  and SW $\frac{1}{4}$  of Sec. 20;  
W $\frac{1}{2}$  of Sec. 29;  
all in TOWNSHIP 48, RANGE 26.

DISTRICT NO. 54 shall consist of the following described areas:

W $\frac{1}{2}$  of NE $\frac{1}{4}$ , NW $\frac{1}{4}$ , N $\frac{1}{2}$  of SW $\frac{1}{4}$  and  
NW $\frac{1}{4}$  of SE $\frac{1}{4}$  of Sec. 3;  
N $\frac{1}{2}$ , NE $\frac{1}{4}$  of SW $\frac{1}{4}$  and N $\frac{1}{2}$  of SE $\frac{1}{4}$  of Sec. 4;  
NE $\frac{1}{4}$  and E $\frac{1}{2}$  of NW $\frac{1}{4}$  of Sec. 5;  
all in TOWNSHIP 48, RANGE 26.

S $\frac{1}{2}$  of NE $\frac{1}{4}$ , S $\frac{1}{2}$  of NW $\frac{1}{4}$  and S $\frac{1}{2}$  of Sec. 28;  
S $\frac{1}{2}$  of NE $\frac{1}{4}$ , E $\frac{1}{2}$  of SW $\frac{1}{4}$  and SE $\frac{1}{4}$  of Sec. 29;  
NE $\frac{1}{4}$ , E $\frac{1}{2}$  of NW $\frac{1}{4}$ , E $\frac{1}{2}$  of SW $\frac{1}{4}$   
and SE $\frac{1}{4}$  of Sec. 32;  
Sec. 33;  
S $\frac{1}{2}$  of NE $\frac{1}{4}$ , S $\frac{1}{2}$  of NW $\frac{1}{4}$  and S $\frac{1}{2}$  of Sec. 34;  
all in TOWNSHIP 49, RANGE 26.

DISTRICT NO. 55 shall consist of the following described areas:

W $\frac{1}{2}$  of NE $\frac{1}{4}$ , W $\frac{1}{2}$  and W $\frac{1}{2}$  of SE $\frac{1}{4}$  of Sec. 6;  
all in TOWNSHIP 48, RANGE 26.

NW $\frac{1}{4}$  and N $\frac{1}{2}$  of SW $\frac{1}{4}$  of Sec. 6;  
SW $\frac{1}{4}$  of NE $\frac{1}{4}$ , S $\frac{1}{2}$  of NW $\frac{1}{4}$ , SW $\frac{1}{4}$   
and W $\frac{1}{2}$  of SE $\frac{1}{4}$  of Sec. 19;  
W $\frac{1}{2}$  of NE $\frac{1}{4}$ , W $\frac{1}{2}$  and W $\frac{1}{2}$  of SE $\frac{1}{4}$  of Sec. 30;  
W $\frac{1}{2}$  of NE $\frac{1}{4}$ , W $\frac{1}{2}$ , W $\frac{1}{2}$  of SE $\frac{1}{4}$  of Sec. 31;  
all in TOWNSHIP 49, RANGE 26.

W $\frac{1}{2}$  of NE $\frac{1}{4}$ , W $\frac{1}{2}$ , W $\frac{1}{2}$  of SE $\frac{1}{4}$  of Sec. 6;  
W $\frac{1}{2}$  of NE $\frac{1}{4}$ , W $\frac{1}{2}$  and W $\frac{1}{2}$  of SE $\frac{1}{4}$  of Sec. 7;  
E $\frac{1}{2}$  of NW $\frac{1}{4}$ , Lots 1, 2 and 3 of Sec. 18;  
SW $\frac{1}{4}$  of NE $\frac{1}{4}$ , S $\frac{1}{2}$  of NW $\frac{1}{4}$ , SW $\frac{1}{4}$   
and W $\frac{1}{2}$  of SE $\frac{1}{4}$  of Sec. 30;  
W $\frac{1}{2}$  of NE $\frac{1}{4}$ , W $\frac{1}{2}$  and W $\frac{1}{2}$  of SE $\frac{1}{4}$  of Sec. 31;  
all in TOWNSHIP 50, RANGE 26.

W $\frac{1}{2}$  of Sec. 30;  
W $\frac{1}{2}$  of NW $\frac{1}{4}$  and SW $\frac{1}{4}$  of Sec. 31;  
all in TOWNSHIP 51, RANGE 26.

Sec's. 1 to 4, both inclusive;  
Sec's. 9 to 13, both inclusive;  
Sec. 14, except Lot 1;  
Sec's. 23 to 26, both inclusive;  
NE $\frac{1}{4}$  of Sec. 35;  
Sec. 36;  
all in TOWNSHIP 48, RANGE 27.

N $\frac{1}{2}$  of Sec. 1;  
Sec. 2;  
Sec. 3;  
Sec. 4;  
Sec. 9;  
Sec. 10;  
Sec. 11;  
Lot 2 and NW $\frac{1}{4}$  of Sec. 13;  
NE $\frac{1}{4}$  of Sec. 14;  
W $\frac{1}{2}$  of Sec. 15;  
Sec. 16;  
Sec. 21;  
Sec. 22;  
S $\frac{1}{2}$  of NE $\frac{1}{4}$ , S $\frac{1}{2}$  of NW $\frac{1}{4}$  and S $\frac{1}{2}$  of sec. 23;  
S $\frac{1}{2}$  of NW $\frac{1}{4}$  and SW $\frac{1}{4}$  of Sec. 24;  
Sec's. 25 to 28, both inclusive;  
Sec's. 33 to 36, both inclusive;  
all in TOWNSHIP 49, RANGE 27.

Sec. 1;  
Sec. 2;  
Sec. 3;  
Sec. 4, except Lot 4;  
Sec's. 9 to 12, both inclusive;  
Lots 1, 2, 3, 4, and 5 of Sec. 13;  
W $\frac{1}{2}$  of Sec. 14;  
Sec. 15;  
Sec. 16;  
Sec. 21;  
Sec. 22;  
W $\frac{1}{2}$  of Sec. 23;  
Lots 1 and 2 of Sec. 24;  
S $\frac{1}{2}$  of Sec. 25;  
W $\frac{1}{2}$  and SE $\frac{1}{4}$  of Sec. 26;  
Sec. 27;  
Sec. 28;  
Sec's 33 to 36 both inclusive;  
all in TOWNSHIP 50, RANGE 27.

NE $\frac{1}{4}$ , E $\frac{1}{2}$  of NW $\frac{1}{4}$ , E $\frac{1}{2}$  of SW $\frac{1}{4}$  and  
SE $\frac{1}{4}$  of Sec. 25;  
E $\frac{1}{2}$  of SE $\frac{1}{4}$  of Sec. 33;  
S $\frac{1}{2}$  of Sec. 34;  
S $\frac{1}{2}$  of Sec. 35;  
NE $\frac{1}{4}$ , E $\frac{1}{2}$  of NW $\frac{1}{4}$  and S $\frac{1}{2}$  of Sec. 36;  
all in TOWNSHIP 51, RANGE 27.

DISTRICT NO. 56 shall consist of the following described areas:

W $\frac{1}{2}$  of NE $\frac{1}{4}$  and W $\frac{1}{2}$  of Sec. 3;  
Sec. 4;  
E $\frac{1}{2}$  of Sec. 5;  
E $\frac{1}{2}$  of Sec. 8;  
Sec. 9, except Lot 5;  
Lots 2, 3, 4, and 5 of Sec. 10;  
Lots 2 and 3 of Sec. 15;  
Sec. 16;  
Lot 2 of Sec. 17;  
E $\frac{1}{2}$  of NE $\frac{1}{4}$ , Lots 1 and 2 of Sec. 21;  
Lot 3, NW $\frac{1}{4}$  of Sec. 22;  
all in TOWNSHIP 49, RANGE 26.

DISTRICT No. 57 shall consist of the following described areas:

W $\frac{1}{2}$  of Sec. 3;  
Sec. 4;  
E $\frac{1}{2}$  of Sec. 5;  
NE $\frac{1}{4}$ , E $\frac{1}{2}$  of NW $\frac{1}{4}$ , E $\frac{1}{2}$  of SW $\frac{1}{4}$   
and SE $\frac{1}{4}$  of Sec. 8;  
Sec. 9;  
W $\frac{1}{2}$  of NE $\frac{1}{4}$ , W $\frac{1}{2}$ , W $\frac{1}{2}$  of SE $\frac{1}{4}$  of Sec. 10;  
SW $\frac{1}{4}$  of NE $\frac{1}{4}$ , S $\frac{1}{2}$  of NW $\frac{1}{4}$ , SW $\frac{1}{4}$   
and W $\frac{1}{2}$  of SE $\frac{1}{4}$  of Sec. 15;  
Sec. 16;  
NE $\frac{1}{4}$ , E $\frac{1}{2}$  of NW $\frac{1}{4}$ , E $\frac{1}{2}$  of SW $\frac{1}{4}$  and SE $\frac{1}{4}$  of  
Sec. 17;  
NE $\frac{1}{4}$ , E $\frac{1}{2}$  of NW $\frac{1}{4}$ ; NE $\frac{1}{4}$  of SW $\frac{1}{4}$   
and N $\frac{1}{2}$  of SE $\frac{1}{4}$  of Sec. 20;  
N $\frac{1}{2}$  of Sec. 21;  
W $\frac{1}{2}$  of Sec. 22;  
all in TOWNSHIP 50, RANGE 26.

W $\frac{1}{2}$  of SW $\frac{1}{4}$  of Sec. 27;  
NE $\frac{1}{4}$  of SW $\frac{1}{4}$ , S $\frac{1}{2}$  of SW $\frac{1}{4}$  and SE $\frac{1}{4}$  of Sec. 28;  
E $\frac{1}{2}$  of SW $\frac{1}{4}$  and SE $\frac{1}{4}$  of Sec. 29;  
NE $\frac{1}{4}$ , E $\frac{1}{2}$  of NW $\frac{1}{4}$ , E $\frac{1}{2}$  of SW $\frac{1}{4}$   
and SE $\frac{1}{4}$  of Sec. 32;  
Sec. 33;  
W $\frac{1}{2}$  of NE $\frac{1}{4}$ , W $\frac{1}{2}$ , W $\frac{1}{2}$  of SE $\frac{1}{4}$  of Sec. 34;  
all in TOWNSHIP 51, RANGE 26.

DISTRICT NO. 58 shall consist of the following described areas:

Sec. 3;  
Sec. 4;  
E $\frac{1}{2}$  of SE $\frac{1}{4}$  of Sec. 5;  
NE $\frac{1}{4}$  of NE $\frac{1}{4}$ ; S $\frac{1}{2}$  of NE $\frac{1}{4}$  and SE $\frac{1}{4}$  of Sec. 8;  
Sec. 9;  
Sec. 10, except S $\frac{1}{2}$  of SE $\frac{1}{4}$ ;  
NW $\frac{1}{4}$  of Sec. 15;  
N $\frac{1}{2}$  of Sec. 16;  
NE $\frac{1}{4}$ , E $\frac{1}{2}$  of NW $\frac{1}{4}$ , NE $\frac{1}{4}$  of SW $\frac{1}{4}$   
and N $\frac{1}{2}$  of SE $\frac{1}{4}$  of Sec. 17;  
all in TOWNSHIP 51, RANGE 26.

S $\frac{1}{2}$  of SW $\frac{1}{4}$  and S $\frac{1}{2}$  of SE $\frac{1}{4}$  of Sec. 21;  
Sec. 28;  
W $\frac{1}{2}$  and SE $\frac{1}{4}$  of Sec. 33;  
S $\frac{1}{2}$  of NE $\frac{1}{4}$ , S $\frac{1}{2}$  of NW $\frac{1}{4}$  and S $\frac{1}{2}$  of Sec. 34;  
all in TOWNSHIP 52, RANGE 26.

DISTRICT NO. 59 shall consist of the following described areas:

SW $\frac{1}{4}$  of Sec. 15;  
S $\frac{1}{2}$  of NE $\frac{1}{4}$ , Lot 1, E $\frac{1}{2}$  of SW $\frac{1}{4}$   
and SE $\frac{1}{4}$  of Sec. 16;  
Sec. 21;  
Sec. 22, except E $\frac{1}{2}$  of NE $\frac{1}{4}$ ;  
W $\frac{1}{2}$  of NW $\frac{1}{4}$  of Sec. 26;  
N $\frac{1}{2}$  of Sec. 27;  
Sec. 28;  
all in TOWNSHIP 51, RANGE 27.

DISTRICT NO. 60 shall consist of the following described areas:

W $\frac{1}{2}$  of NW $\frac{1}{4}$  and NW $\frac{1}{4}$  of SW $\frac{1}{4}$  of Section 5;  
N $\frac{1}{2}$ , N $\frac{1}{2}$  of SW $\frac{1}{4}$  and N $\frac{1}{2}$  of SE $\frac{1}{4}$  of Sec. 6;  
SW $\frac{1}{4}$  of NE $\frac{1}{4}$ , S $\frac{1}{2}$  of NW $\frac{1}{4}$ , SW $\frac{1}{4}$   
and W $\frac{1}{2}$  of SE $\frac{1}{4}$  of Sec. 7;  
W $\frac{1}{2}$  of NE $\frac{1}{4}$ , W $\frac{1}{2}$  and W $\frac{1}{2}$  of SE $\frac{1}{4}$  of Sec. 18;  
NW $\frac{1}{4}$  of NE $\frac{1}{4}$  and N $\frac{1}{2}$  of NW $\frac{1}{4}$  of Sec. 19;  
all in Township 51, RANGE 26.

W $\frac{1}{2}$  of NE $\frac{1}{4}$ , W $\frac{1}{2}$  and SE $\frac{1}{4}$  of Sec. 31;  
W $\frac{1}{2}$  of SW $\frac{1}{4}$  of Sec. 32;  
all in TOWNSHIP 52, RANGE 26.

Sec. 1;  
Sec. 2;  
NE $\frac{1}{4}$ , Lots 3 and 4, E $\frac{1}{2}$  of SW $\frac{1}{4}$   
and SE $\frac{1}{4}$  of Sec. 3;  
NE $\frac{1}{4}$  of Sec. 10;  
N $\frac{1}{2}$  and E $\frac{1}{2}$  of SE $\frac{1}{4}$  of Sec. 11;  
Sec. 12;  
Sec. 13, except S $\frac{1}{2}$  of SW $\frac{1}{4}$ ;  
NE $\frac{1}{4}$  and N $\frac{1}{2}$  of SE $\frac{1}{4}$  of Sec. 14;  
all in TOWNSHIP 51, RANGE 27.

E $\frac{1}{2}$  of Sec. 35;  
Sec. 36;  
all in TOWNSHIP 52, RANGE 27.



DISTRICT NO. 61 shall consist of the following described areas:

S $\frac{1}{2}$  of Sec. 19;  
N $\frac{1}{2}$  and N $\frac{1}{2}$  of SW $\frac{1}{4}$  of Sec. 30;  
all in TOWNSHIP 52, RANGE 26.

SE $\frac{1}{4}$  of Sec. 23;  
S $\frac{1}{2}$  of Sec. 24;  
NE $\frac{1}{4}$  and N $\frac{1}{2}$  of SE $\frac{1}{4}$  of Sec. 25;  
all in TOWNSHIP 52, RANGE 27.

DISTRICT NO. 62 shall consist of the following described areas:

SW $\frac{1}{4}$  of Sec. 5;  
Sec. 6, except Lots 1 and 2;  
Sec. 7;  
W $\frac{1}{2}$  of Sec. 8;  
N $\frac{1}{2}$  of Sec. 17;  
N $\frac{1}{2}$  of Sec. 18;  
all in TOWNSHIP 52, RANGE 26.

Sec's. 1 to 4, both inclusive;  
Sec's 9 to 12 both inclusive;  
N $\frac{1}{2}$  of Sec. 13;  
N $\frac{1}{2}$  of Sec. 14;  
N $\frac{1}{2}$ , SW $\frac{1}{4}$  and W $\frac{1}{2}$  of SE $\frac{1}{4}$  of Sec. 15;  
Sec. 16;  
Sec. 21;  
N $\frac{1}{2}$  of Sec. 28;  
all in TOWNSHIP 52, RANGE 27.

#### SECTION 3; USE OF PROPERTY IN RESTRICTED DISTRICTS:

Except as otherwise hereinafter provided, no building or structures shall be erected, occupied, or used by any person or persons as an established home, or with intent to establish a home therein in any restricted district unless such home is necessary for use and is used solely in connection with a mine, quarry, gravel pit, hydro dam, private dam, flowage area, transmission line or substation. Buildings and structures in the process of construction on the effective date of this ordinance may be completed and occupied as homes, free from the foregoing restrictions. The word "home" as used herein shall not be construed to include any building or structure occupied solely for hunting, fishing, or summer residential purposes, or for the harvesting of wild crops during the legal or customary seasons for such activities.

#### SECTION 4. UNRESTRICTED DISTRICTS:

Unrestricted districts shall comprise all unincorporated areas within the county not specifically included within restricted districts as hereinbefore defined. This ordinance imposes no restrictions upon uses or occupancies within such unrestricted districts.

#### SECTION 5. NON-CONFORMING USES AND OCCUPANCIES:

Any lawful use or occupancy of any land or premises existing on the effective date of this ordinance, or any applicable amendment thereof which does not conform to the provisions thereof may be continued, but if such non-conforming use or occupancy is discontinued for a period of more than two years, any subsequent use or occupancy of such land or premises shall conform with the provisions of this ordinance or amendment, as the case may be; provided, however, that if the state acquires title to any land or premises all further use or occupancy thereof shall be a conforming use or occupancy.

#### SECTION 6. HEARINGS ON OBJECTIONS TO ORDINANCE :

Any person aggrieved by any provision of this ordinance, or any amendment thereof, may, within sixty days after the taking effect of such provision, demand a separate hearing thereon before the county board. Such demand shall be in writing, shall specify in detail the ground of the objections, and shall be filed with the county auditor. Thereupon further proceedings shall be had as provided by the law.

#### SECTION 7. RELIEF FROM LITERAL ENFORCEMENT.

Where the literal enforcement of any provision of this ordinance would result in great practical difficulties, unnecessary hardship, or injustice, the county board, upon petition of the person so aggrieved or so affected, may grant relief as provided by law.

#### SECTION 8. APPEALS TO DISTRICT COURT:

Decision of the county board in matters affected by this ordinance may be appealed to the district court in the manner provided by law.

SECURITY-PRINTING COMPANY, ST. CLOUD, MINN. 124308

SECTION 9. PENALTIES:

The provisions of this ordinance have the force and effect of law. Any violations of such provisions is a misdemeanor and is punishable as such. Any such violation or threatened violation may be restrained as provided by law.

SECTION 10. SEVERABILITY:

The provisions of this ordinance shall be deemed severable, and if any such provision or the application thereof to any person or circumstance is held invalid, the remainder of the ordinance and the application of such provision to other persons and circumstances shall not be affected thereby.

SECTION 11. EFFECTIVE DATE:

This ordinance becomes effective after publication for three successive weeks and upon the filing of proof thereof in the office of the county auditor as provided by law.

Adopted and approved by the County Board of Aitkin County this 2nd day of November, 1944.

Chas. R. Beyreuther  
Chairman

Attest:

Claude V. Cline  
County Auditor

I, Claude V. Cline, County Auditor of Aitkin County, Minnesota, do hereby certify that the foregoing is a true copy of the Zoning Ordinance for Aitkin County as adopted and approved by the County Board of Aitkin County on the 2nd. day of November, 1944.

Given under my hand and seal this 23rd day of February, 1945.

(Seal of County Auditor)

Claude V. Cline  
County Auditor, Aitkin County,  
Minnesota.

→ On pages 11 and 12 hereof is copy of plat attached to the foregoing instrument. Because the plat is so large the plat has been cut in two and the upper half of the plat appears on page 11 and the lower half of the plat on page 12.

(Continued from page 10)

The plat on this page and the other half of the plat is the plat referred to in Zoning Ordinance on pages 1 to 10 hereof.

SECURITY PRINTING COMPANY, ST. CLOUD, MINN. 5624398

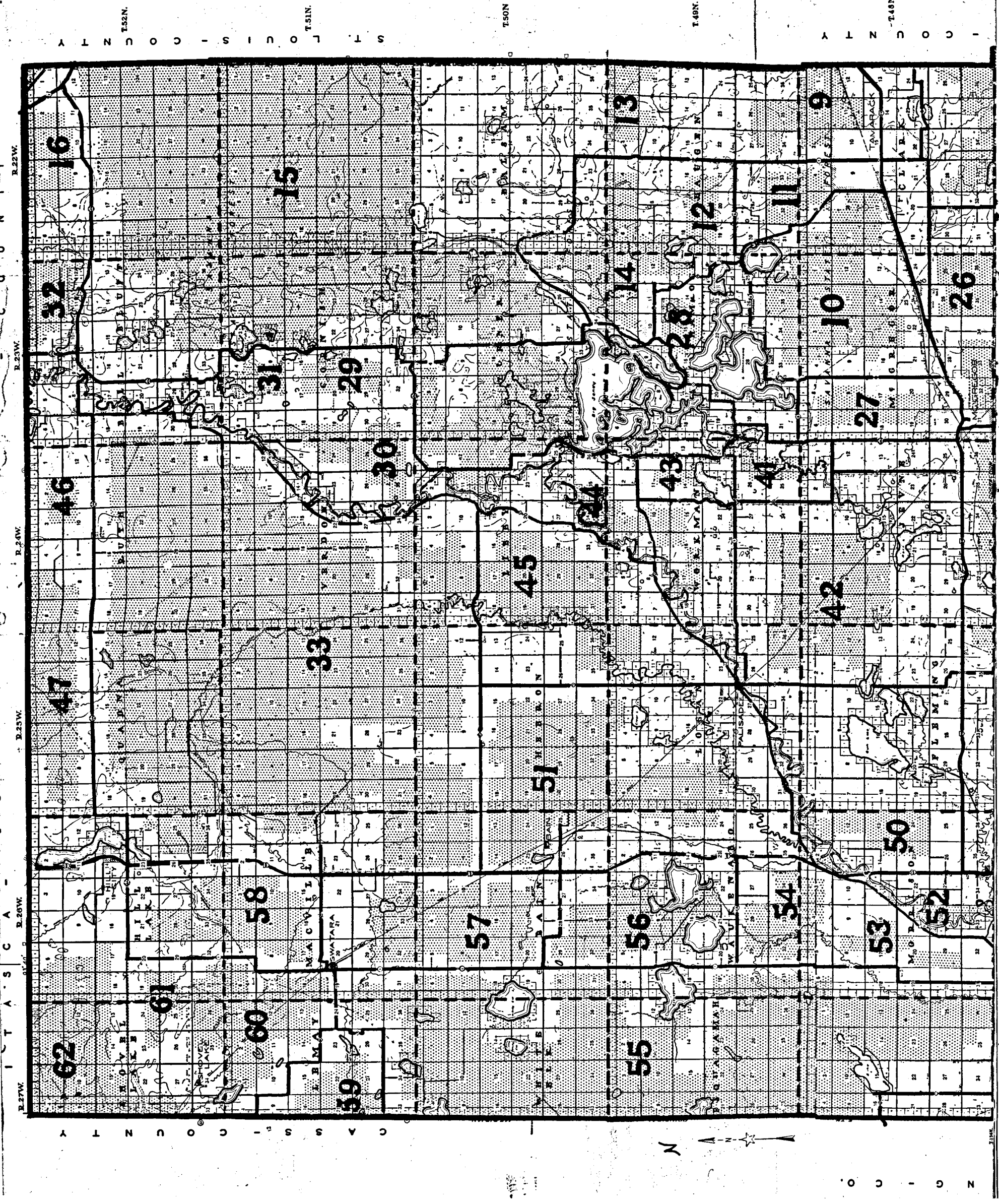

AITKIN COUNTY

ST. LOUIS COUNTY

CASS COUNTY

NOON

SECURITY PRINTING COMPANY, ST. CLOUD, MINN. 124398

(Continued from page 11 hereof)

22  
23  
24  
25  
26  
27

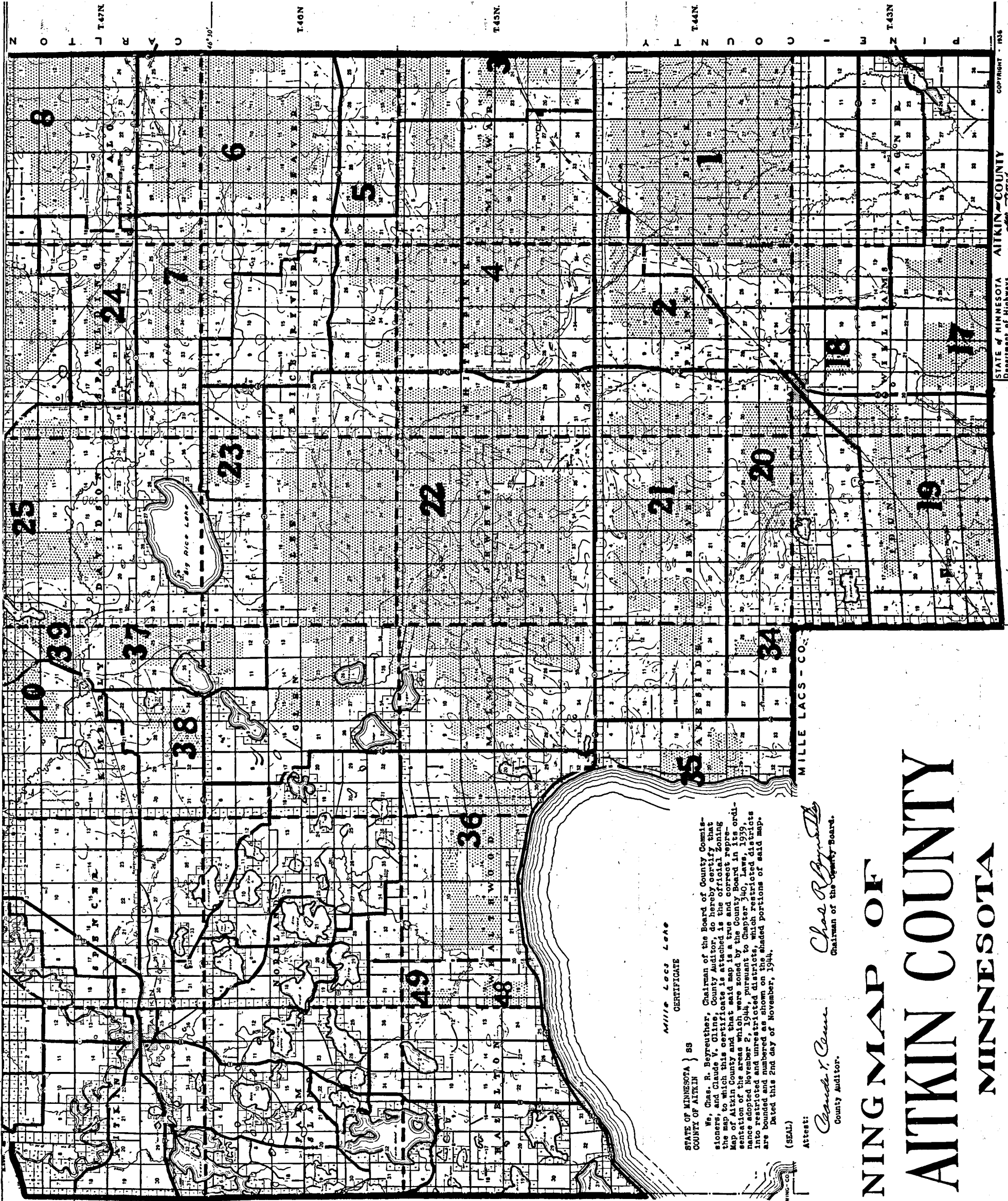

MILLE LACS LEAK  
CERTIFICATE

STATE OF MINNESOTA }  
COUNTY OF AITKIN } SS

We, Chas. R. Beyreuther, Chairman of the Board of County Commissioners, and Claude V. Gline, County Auditor, do hereby certify that the map to which this certificate is attached is the official zoning map of Aitkin County and that said map is a true and correct representation of the areas which were zoned by the Board in its ordinance adopted November 2, 1944, pursuant to the provisions of the Minnesota Restriction and Unrestricted Districts Law, 1919, which restricted districts into restricted and unrestricted districts, which restricted districts are bounded and numbered as shown on the shaded portions of said map. Dated this 2nd day of November, 1944.

(SEAL)

Attest:  
*Charles V. Gline*  
County Auditor.

*Chas. R. Beyreuther*  
Chairman of the County Board.

ZONING MAP OF  
**AITKIN COUNTY**  
MINNESOTA

STATE OF MINNESOTA  
Department of Highways  
AITKIN COUNTY  
COPYRIGHT 1938